

## Modular Cooking - Grandis

### Gas - Hot Top

#### NGHT 8-90 OV GR



Due to continuous technical development, the image shown may not represent the latest design of the unit.

#### DESCRIPTION

Modular gas hot top with 14 kW concentric burner and Static 2/1 GN oven with 8 kW tubular burners.

Usable for boiling, steaming, frying, braising, simmering and steam frying. Oven module usable for roasting and baking.

Made of AISI 304 with 2 mm top thickness, griddle is made of Molybdenum steel with 18 mm thickness, powered with circular cast iron burner that heats up the hot top in concentric distribution. Central temperature can reach up to 550 degree Celcius. Oven is sized for 2/1 GN with reflective AISI cavity for superior heat transfer.

#### OTHER AVAILABLE MODELS

- NGHT 12-90 OC GR
- NGHT 12-90 OV GR
- NGHT 12-90 SD GR
- NGHT 8-90 OC GR
- NGHT 8-90 SD GR

#### MAIN FEATURES

- Powered with 14 kW circular cast iron burner.
- Static 2/1 GN gas oven is powered with 8 kW chrome-plated tubular burner with 2/1 GN cavity and reflective AISI chamber to improve thermal efficiency. Oven is equipped with piezo ignition system with rubber cover.
- Hot top griddle is made of 18 mm thick Molybdenum steel for high thermal performance.
- Concentric heat distribution. Center temperature can reach up to 550 degree Celcius. Griddle center can be removed for service, usable for wok cooking.
- Piezzo ignition system with rubber cover.
- Equipped with flame failure device.

#### CONSTRUCTION

- External construction entirely with AISI 304.
- Top panel with 2 mm thickness. Orbital surface finishing: resistant toward scratches.
- Front panel is constructed of 1 mm AISI 304 with satin surface finish.
- Side panel is constructed of 0.8 mm AISI 304 with satin surface finish.
- Adjustable +/- 25 mm AISI leg.
- Connector between Grandis product on the front and the back.

#### INCLUDED ACCESSORIES

- G20 Conversion Kit
- SS Hook to remove griddle inner plate.
- 2/1 GN oven wire tray (1 pcs.).

#### OPTIONAL ACCESSORIES

- Joint clip GR.

PT. NAYATI INDONESIA

[www.nayati.com](http://www.nayati.com)

Nayati reserves the right to make product alterations and or price adjustments at any time and can not be held responsible for any printing errors or omissions.

## FRONT

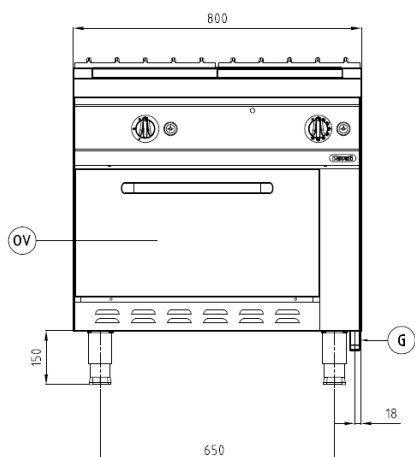

## TOP

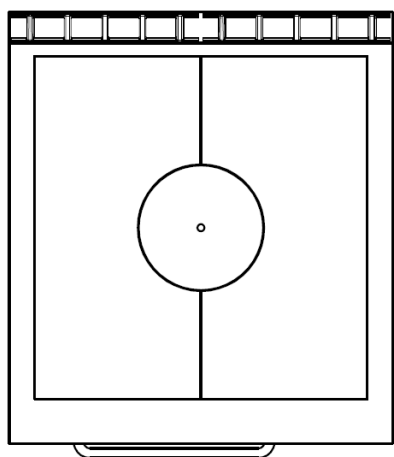

## SIDE

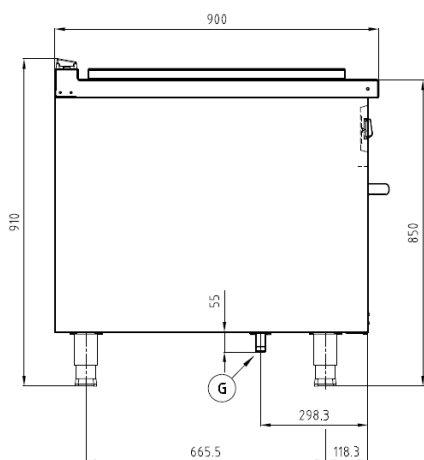

\*Overall dimension in mm

## TECHNICAL DATA

### External Dimensions

Width	: 800 mm
Depth	: 900 mm
Height	: 850/910 mm

### Cooking Surface

Cooking zones	: 694 x 715 mm
---------------	----------------

### Gas Power Rating

Heat input total	: LPG/Natural Gas 22 kW
No. of burners	: 2
Control type	: Hot Top: High - low power control, Oven: Modulating temperature control

Gas type options	: LPG G30, G31 Natural Gas G20, G25
------------------	--

### Connections

Gas	: DN 20 (3/4")
Water	: N/A
Drain	: N/A

### Heat & Steam Emissions

Direct heat emission	: 7 kW
Latent heat emission	: 3.28 kW
Steam emission	: 4.81 kg/h

### PACKAGING DATA

Width	: 830 mm
Depth	: 930 mm
Height	: 1030 mm
Volume	: 0.80 m <sup>3</sup>

### WEIGHT

Net Weight	: 190 kg
Gross Weight	: 213 kg

PT. NAYATI INDONESIA

[www.nayati.com](http://www.nayati.com)

Nayati reserves the right to make product alterations and or price adjustments at any time and can not be held responsible for any printing errors or omissions.

22/03/2022