

## Oriental Cooking - Roaster & Grill

### Gas - Duck Roaster

#### NGDR 910 H



Due to continuous technical development, the image shown may not represent the latest design of the unit.

#### DESCRIPTION

Gas duck roaster, equipped with a powerful, atmospheric high-pressure burner of 35 kW power rate and a roasting capacity for twelve ducks.

Made of stainless steel and designed for ease of use with a lift top-lid to access the duck hanging-rail. Equipped with an observation door, ventilation cover, temperature gauge and a drainage area to collect the dropping oil.

#### OTHER AVAILABLE MODELS

- NGDR 910
- NGDR 900 CE (double layer)

#### MAIN FEATURES

- Powerful atmospheric high-pressure burner with a power rate of 35 kW.
- Ventilation opening with cover in the top lid.
- Piezo ignition.
- Equipped with pilot burner, safety thermocouple, gas valve, gas knob.
- Stainless steel rail for twelve ducks.
- Oil/grease collection area with drainage.
- Temperature gauge.

#### CONSTRUCTION

- Unit made of stainless steel AISI 304.
- Dome (three parts) and lid made of stainless steel AISI 304 (1.0 mm).
- Legs made of stainless steel AISI 304 (6 mm).
- Types of installations: free standing.
- Unit made of high-grade stainless steel.

#### INCLUDED ACCESSORIES

- N/A

#### OPTIONAL ACCESSORIES

- Stainless steel 9" roast duck hook.
- S-hook 15" with wooden handle .

## FRONT

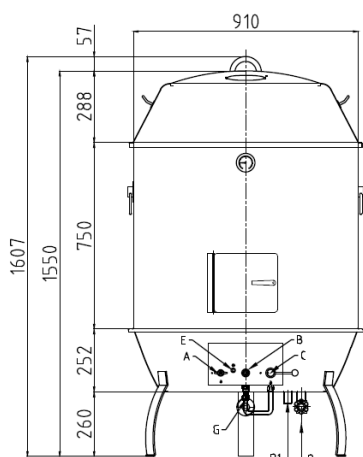

## TOP

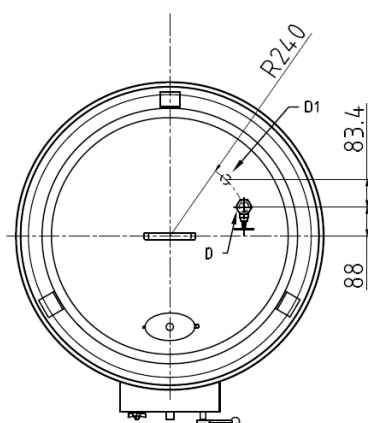

## SIDE

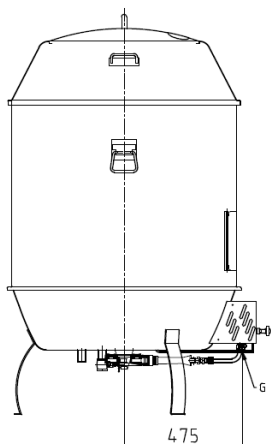

\*Overall dimension in mm

## TECHNICAL DATA

### External Dimensions

Width	: Ø 910 mm
Depth	: Ø 910 mm
Height	: 1607 mm

### Cooking Surface

Cooking zones	: 12 ducks, Ø 900 mm
---------------	----------------------

### Gas Power Rating

Heat input total	: LPG 35 kW
No. of burners	: 1
Control type	: High-low power control
Gas type options	: LPG G30, G31 LNG N/A

### Connections

Gas	: DN15 (1/2")
Water	: N/A
Drain	: DN25 (1") & DN32 (1 1/4")

### Heat & Steam Emissions

Direct heat emission	: LPG 12.25 kW
Latent heat emission	: LPG 7.00 kW
Steam emission	: LPG 10.29 kg/h

### PACKAGING DATA

Width	: 940 mm
Depth	: 940 mm
Height	: 1670 mm
Volume	: 1.48 m <sup>3</sup>

### WEIGHT

Net Weight	: 52 kg
Gross Weight	: 81 kg

PT. NAYATI INDONESIA

[www.nayati.com](http://www.nayati.com)

Nayati reserves the right to make product alterations and or price adjustments at any time and can not be held responsible for any printing errors or omissions.

02/10/2020