

Modular Cooking - Grandis

Gas - Fryer

NGF 4-90 GR



Due to continuous technical development, the image shown may not represent the latest design of the unit.

DESCRIPTION

Modular gas fryer with 900 mm depth and single tank with 21 kW AISI tubular burners. Equipped with swing door.

Usable for deep frying.

Made of AISI 304 with 2 mm top thickness, manually ignited, includes dedicated cold zone to prolong usable oil lifetime and better fried products. Includes fryer basket, tank cover, crumb filter and oil drain kit.

OTHER AVAILABLE MODELS

- NGF 8-90 GR

MAIN FEATURES

- Powered with 21 kW stainless-steel burners.
- Oil capacity of 23 liters
- Frying basket, tank cover, oil drain kit, and crumb filter included.
- Fully welded fryer tank.
- Drain valve with 1" on the front surface provided
- Thermal-cut off when overheated.

CONSTRUCTION

- External construction entirely with AISI 304.
- Top panel with 2 mm thickness. Orbital surface finishing: resistant toward scratches.
- Front panel is constructed of 1 mm AISI 304 with satin surface finish.
- Side panel is constructed of 0.8 mm AISI 304 with satin surface finish.
- Adjustable +/- 25 mm AISI leg.
- Cabinet executed with H2 radius.
- Connector between Grandis product on the front and the back.

INCLUDED ACCESSORIES

- G20 Conversion Kit
- 2 x Fryer Baskets.
- Crumb filter.
- Oil drain pipe and container.
- Fryer tank lid.

OPTIONAL ACCESSORIES

- Joint clip GR.

PT. NAYATI INDONESIA

www.nayati.com

Nayati reserves the right to make product alterations and or price adjustments at any time and can not be held responsible for any printing errors or omissions.

FRONT

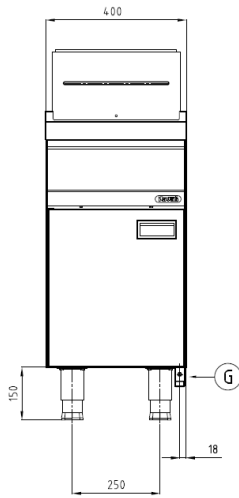

TOP

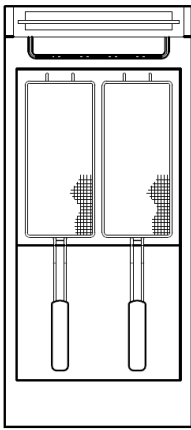

SIDE

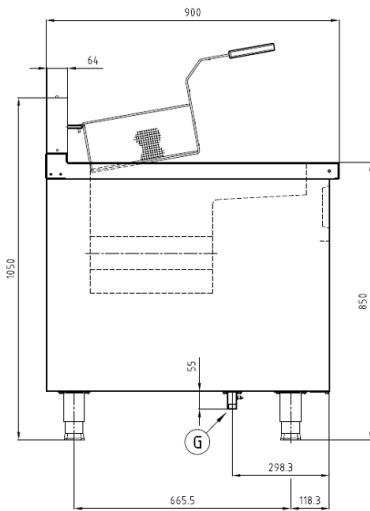

*Overall dimension in mm

TECHNICAL DATA

External Dimensions

Width : 400 mm
Depth : 900 mm
Height : 850/1050 mm

Cooking Surface

Cooking zones : 23 liters, 350 x 377 mm

Gas Power Rating

Heat input total : LPG/Natural Gas 21 kW
No. of burners : 4
Control type : Modulating temperature control
Gas type options : LPG G30, G31
Natural Gas G20, G25

Connections

Gas : DN 20 (3/4")
Water : N/A
Drain : DN 25 (1")

Heat & Steam Emissions

Direct heat emission : 1.89 kW
Latent heat emission : 14.70 kW
Steam emission : 21.63 kg/h

PACKAGING DATA

Width : 430 mm
Depth : 930 mm
Height : 1170 mm
Volume : 0.47 m³

WEIGHT

Net Weight : 78 kg
Gross Weight : 94 kg