

**Refrigeration - Undercounter**  
**Undercounter Chiller - Drawer**  
**NRT 2C 750 4D**



Due to continuous technical development, the image shown may not represent the latest design of the unit.

#### DESCRIPTION

Undercounter chiller with 750 mm depth with splashback and 4 drawers in 2 compartments.

Operating temperature from 2 to 12 degree Celcius.

Made entirely of AISI 304, internally and externally. User interface with digital control with black/white contrast for ease of monitoring. Non-CFC and HCFC polyurethane insulation with density of 40 kg per cubic meter. Powered with refrigerant type of R404a.

#### OTHER AVAILABLE MODELS

- NRT 1C 750 2D
- NRT 1C 750 3D
- NRT 2C 750 6D
- NRT 3C 750 6D
- NRT 3C 750 9D
- NRTA 1C 750 2D
- NRTA 1C 750 3D
- NRTA 2C 750 4D
- NRTA 2C 750 6D
- NRTA 3C 750 6D
- NRTA 3C 750 9D

#### MAIN FEATURES

- Undercounter chiller with 750 mm depth with splashback and 4 drawers in 2 compartments. Operating temperature from 2 to 12 degree Celcius.
- Internal volume of 320 liters with size of 926 x 620 x 570 mm.
- User interface with electronic control. Designed with black/white contract for ease of monitoring.
- Designed to perform under tropical with ambient condition of 38 degree Celcius
- Ducted cooling design, ensuring uniform temperature distribution among compartments.
- Cassette type refrigeration system designed for simple service and maintenance. Universal size for both chiller and freezer systems.
- Removable racking system.
- Includes lock and master key for all compartments.
- Self-closing doors with removable magnetic balloon gasket.
- Includes protection component against voltage drops.
- Fan-assisted defrost system.

#### CONSTRUCTION

- External construction entirely with AISI 304. Including back panel.
- Internal construction entirely with AISI 304 with 2B surface finish.
- Top and front panel with AISI 304 with 1.0 mm thickness. Top profile is 45 mm height. Satin surface finishing.
- Side panel with AISI 304 with 0.5 mm thickness. Satin surface finishing.
- Door thickness of 42 mm.
- Internal chamber bottom is designed with radius for hygiene.
- Adjustable +/- 25 mm AISI leg. Can be dismantled and ready for concrete plinth installation.
- Condensor circulation with filter of 300 x 280 mm.
- Splashback model is equipped with 100 x 30 mm splashback.
- Body height is 700 mm without work top.

PT. NAYATI INDONESIA

[www.nayati.com](http://www.nayati.com)

Nayati reserves the right to make product alterations and or price adjustments at any time and can not be held responsible for any printing errors or omissions.

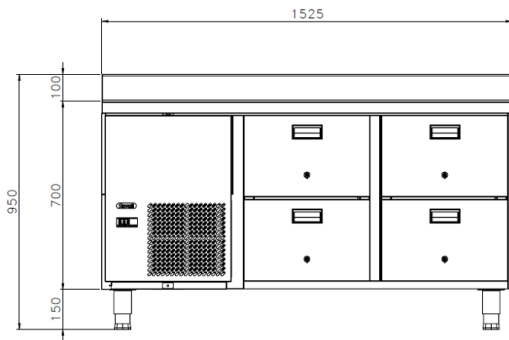
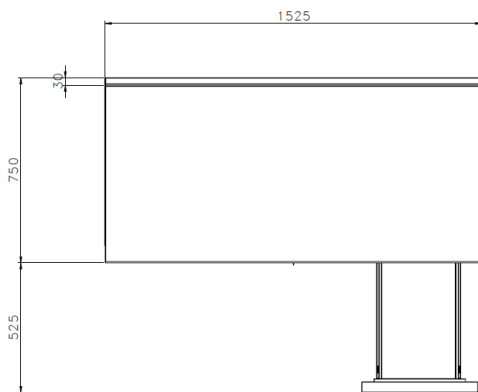
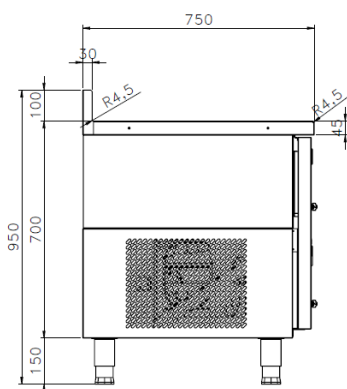
**FRONT****TOP****SIDE**

\*Overall dimension in mm

**TECHNICAL DATA****External Dimensions**

Width	: 1525 mm
Depth	: 750 mm
Height	: 850 mm

**Internal Dimensions**

Width	: 926 mm
Depth	: 620 mm
Height	: 570 mm
Volume	: 320 liters

**Refrigeration Properties**

Refrigerant	: R404a
Temperature	: 2 C ... 5 C
Control type	: Temperature control & configuration

**Electrical Supply Data**

Energy consumption	: 8.8 kW / 24 hours
Connected Load	: 524 W
Refrigeration Output	:
	: 612 W -10 degree C Evap. temperature

Voltage	: 230V, 1NPE AC / 50 Hz
Recommended fuse	: 13 A (slow)
Starting current	: 16 A
Running current	: 2.74 A

**Heat Emissions**

Direct heat emission	: 0.26 kW
----------------------	-----------

**PACKAGING DATA**

Width	: 1555 mm
Depth	: 780 mm
Height	: 970 mm
Volume	: 1.18 m <sup>3</sup>

**WEIGHT**

Net Weight	: 118 kg
Gross Weight	: 139 kg

**INCLUDED ACCESSORIES**

- Nylon-coated wire racks 325 x 540 mm.
- Power cable, H07RN-F (3x 2.5 mm).
- Condensor filter 300 x 280 mm.
- Door locks kit.

**OPTIONAL ACCESSORIES**

- Extra Nylon-coated wire racks 325 x 540 mm.

**PT. NAYATI INDONESIA**[www.nayati.com](http://www.nayati.com)

Nayati reserves the right to make product alterations and or price adjustments at any time and can not be held responsible for any printing errors or omissions.

10/09/2021