

Modular Cooking - Meritus

Electric - Bain Marie

NEBM 8-75 (ME1)



Due to continuous technical development, the image shown may not represent the latest design of the unit.

DESCRIPTION

Modular electric bain marie with 750 mm depth and 2 x 1/1 GN capacity with 30 liters of water bath, heated with rod heating elements with a total of 4 kW connected load.

Usable for food warming before food distribution.

Made of AISI 304 with 1.5 mm top thickness, temperature controlled, fully welded basin with 1 x 1/1 GN capacity.

OTHER AVAILABLE MODELS

- NEBM 4-75 (ME1)

MAIN FEATURES

- Powered with 2 x 2 kW rod heating elements.
- Tank is made of AISI 304 with height of 210 mm.
- Usable water bath volume of 30 liters, equipped with overflow pipe.
- Manual water filling system with knob integrated on the front panel.
- Temperature control from 30 degree Celcius to 90 degree Celcius.
- Thermal-cut off when overheated.

CONSTRUCTION

- External construction entirely with AISI 304.
- Top panel with 1.5 mm thickness. Orbital surface finishing: resistant toward scratches.
- Front panel is constructed of 0.8 mm AISI 304 with satin surface finish.
- Side panel is constructed of 0.8 mm AISI 304 with satin surface finish.
- Tubular, height adjustable (-3...+50 mm) stainless steel legs.
- Nayati connection system between Meritus products on the top panels and cabinets.
- Cabinet executed with H2 radius.
- Deep drawn front panel to minimize liquid penetration to the internal part.
- Gasket protection behind the knobs to prevent water to seeping in, prolonging main heating regulation parts.
- IPX5 water protection level.

INCLUDED ACCESSORIES

- Joining clip ME1

OPTIONAL ACCESSORIES

- Power cable, H07RN-F (5 x 1.5 mm) p/mtr.
- Swing door 8-75 ME1.

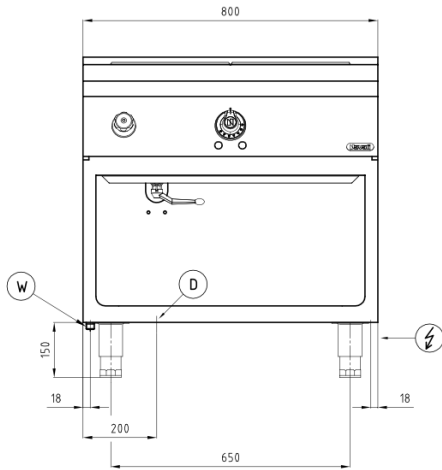
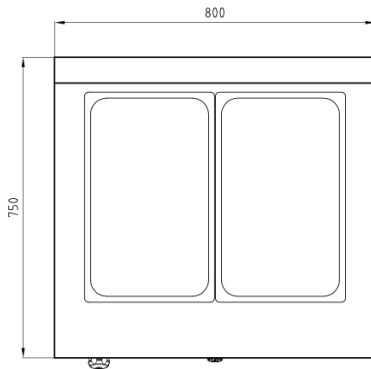
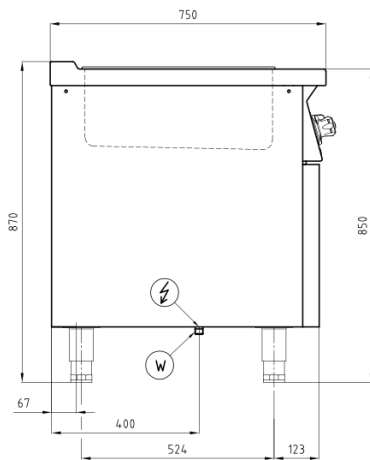
FRONT**TOP****SIDE**

*Overall dimension in mm

TECHNICAL DATA**External Dimensions**

Width	: 800 mm
Depth	: 750 mm
Height	: 850/870 mm

Cooking Surface

Cooking zones	: 2 x GN 1/1, 630 x 510 mm
Heating zones	: 1
Control type	: Modulating temperature control

Electrical Supply Data

Total connected load	: 4 kW
Voltage	: 400V, 2PNE AC /50-60Hz
Recommended fuse	: 13 A (slow)

Connections

Water	: DN 15 (1/2")
Drain	: DN 20 (3/4")

Heat & Steam Emissions

Direct heat emission	: 0.50 kW
Latent heat emission	: 0.80 kW
Steam emission	: 1.18 kg/h

PACKAGING DATA

Width	: 830 mm
Depth	: 780 mm
Height	: 990 mm
Volume	: 0.64 m ³

WEIGHT

Net Weight	: 70 kg
Gross Weight	: 93 kg