

Asian Cooking - Electric Steamer

Electric - Dim Sum Steamer

NESB 15-90



Due to continuous technical development, the image shown may not represent the latest design of the unit.

DESCRIPTION

Electric dim sum steamer two individually controlled steaming engines for fourteen dim sum trays steaming capacity. Equipped with high-efficient heaters with a total of 54 kW connected load for quick steam.

Three steaming operations to achieve the ideal balance between performance and energy-saving when needed. The cold water supply with one swivel faucet mounted on the backsplash, and the deck cleaning system guarantees an easy cleaning and a maximum of hygiene.

Powerful and suitable for mass production of dim sum and steamed food, the NESB steamer is the perfect choice for high-frequent Asian restaurants.

OTHER AVAILABLE MODELS

- NESB 9-90

MAIN FEATURES

- High-efficient heaters with a total connected load of 54 kW.
- Three level rotary switch with control knob and function indication lights.
- Two steam box engines with automatic filling system and security thermostats.
- Slanted, deep drawn, reinforced top panel with drain channel and removable strainer in the front for easy operation.
- Deck cooling & cleaning system with spray nozzles for a maximum hygiene and easy operation.
- Cold water supply with one swivel faucet mounted on the backsplash.
- CE certified unit.

CONSTRUCTION

- Sturdy frame made of stainless steel AISI 304.
- Slanted, reinforced deep drawn stainless steel top panel (1.2 mm), AISI 304 with hairline surface pattern.
- Front and side panels made of stainless steel AISI 304 with hairline surface pattern (0.8 mm).
- Backsplash made of stainless steel AISI 304 with hairline surface pattern (0.8 mm).
- Tubular, height adjustable (± 10 mm) stainless steel legs.
- Types of installations: free standing or placed on a plinth.
- Frame, top and panels, all made of high-grade stainless steel.

INCLUDED ACCESSORIES

- Dim sum plate with seven holes (2 pcs).

OPTIONAL ACCESSORIES

- Dim sum tray kit - two levels with lid for max. 24 pcs bamboo trays \varnothing 130 mm.
- Power cable type: 2 pcs H07RN-F (5 x 10 mm²).

FRONT

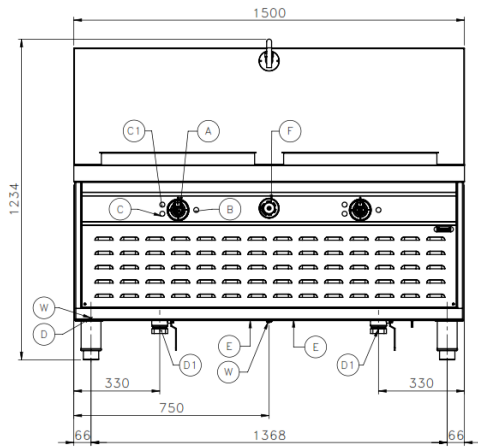

TOP

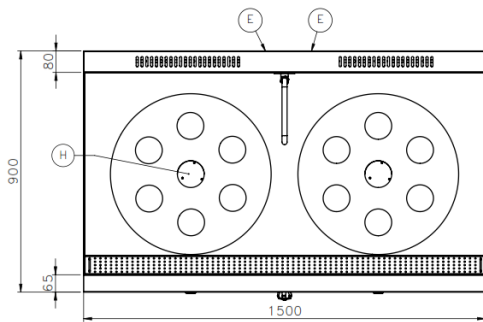

SIDE

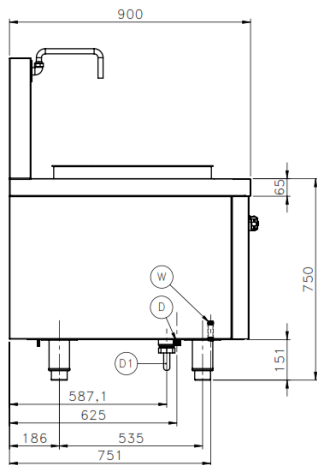

*Overall dimension in mm

TECHNICAL DATA

External Dimensions

Width : 1500 mm
 Depth : 900 mm
 Height : 750/1200 mm

Cooking Surface

Cooking zones : Ø 600 (2 pcs) mm
 Heating zones : 2 x 27 kW
 Control type : High-low power control

Electrical Supply Data

Total connected load : 54 kW (2 x 27 kW)
 Voltage : 400V, 3PNE AC /50-60Hz
 Recommended fuse : 2 x 50 A (slow)

Connections

Water : DN15 (1/2")
 Drain : DN25 (1") & DN40 (1 1/2")

Heat & Steam Emissions

Direct heat emission : 6.48 kW
 Latent heat emission : 9.72 kW
 Steam emission : 14.32 kg/h

PACKAGING DATA

Width : 1600 mm
 Depth : 1020 mm
 Height : 1400 mm
 Volume : 2.28 m³

WEIGHT

Net Weight : 218 kg
 Gross Weight : 314 kg