

## Refrigeration - Cabinet

### Cabinet Chiller

#### NR GF2-2/1



Due to continuous technical development, the image shown may not represent the latest design of the unit.

#### DESCRIPTION

Cabinet chiller with 2 full-sized doors.

Operating temperature from 2 to 12 degree Celcius.

Made entirely of AISI 304, internally and externally. User interface with digital control with black/white contrast for ease of monitoring. Non-CFC and HCFC polyurethane insulation with density of 40 kg per cubic meter. Powered with refrigerant type of R404a.

#### OTHER AVAILABLE MODELS

- NR G2-2/1
- NR G4-2/1
- NR GF1-2/1

#### MAIN FEATURES

- Cabinet chiller with full-sized 2 doors. Operating temperature from 2 to 12 degree Celcius.
- Internal volume of 1280 liters with size of 1280 x 725 x 1388 mm.
- User interface with electronic control. Designed with black/white contract for ease of monitoring.
- Designed to perform under tropical with ambient condition of 38 degree Celcius
- Removable racking system.
- Includes lock and master key for all compartments.
- Self-closing doors with removable magnetic balloon gasket.
- Includes protection component against voltage drops.
- Fan-assisted defrost system.

#### CONSTRUCTION

- External construction entirely with AISI 304. Back panel is constructed from POE material.
- Internal construction entirely with AISI 304 with 2B surface finish.
- Door thickness of 42 mm.
- Side panel with AISI 304 with 0.5 mm thickness. Satin surface finishing.
- Internal chamber bottom is designed with radius for hygiene.
- Adjustable +/- 25 mm AISI leg.
- Condensing unit is covered with front panel of 0.8 mm thick, 450 mm high and 60 mm panel.

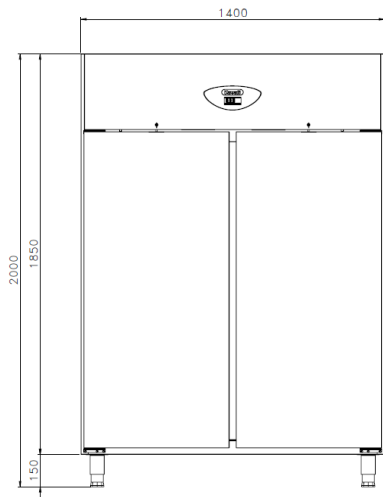
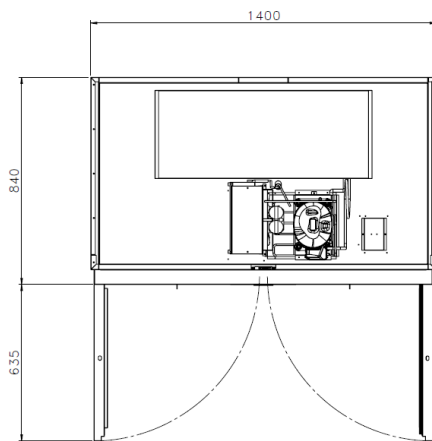
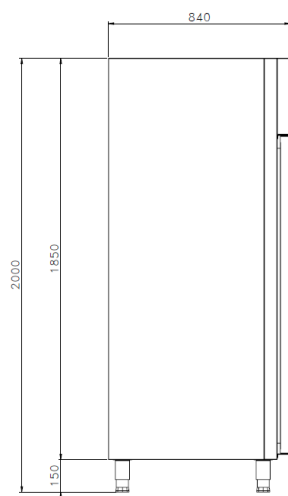
**FRONT****TOP****SIDE**

\*Overall dimension in mm

**TECHNICAL DATA****External Dimensions**

Width	: 1400 mm
Depth	: 840 mm
Height	: 2000 mm

**Internal Dimensions**

Width	: 1280 mm
Depth	: 725 mm
Height	: 1388 mm
Volume	: 1280 liters

**Refrigeration Properties**

Refrigerant	: R404a
Temperature	: 2 C ... 5 C
Control type	: Temperature control & configuration

**Electrical Supply Data**

Energy consumption	: 13.6 kW / 24 hours
Connected Load	: 810 W
Refrigeration Output	:
	976 W -10 degree C Evap. temperature

Voltage	: 230V, 1NPE AC / 50 Hz
Recommended fuse	: 20 A (slow)
Starting current	: 19 A
Running current	: 4.27 A

**Heat Emissions**

Direct heat emission	: 0.39 kW
----------------------	-----------

**PACKAGING DATA**

Width	: 1430 mm
Depth	: 880 mm
Height	: 2120 mm
Volume	: 2.67 m <sup>3</sup>

**WEIGHT**

Net Weight	: 214 kg
Gross Weight	: 239 kg

**INCLUDED ACCESSORIES**

- Nylon-coated wire racks 538 x 600 mm.
- Power cable, H07RN-F (3x 2.5 mm).
- Door locks kit.

**OPTIONAL ACCESSORIES**

- Extra Nylon-coated wire racks 538 x 600 mm.