

## Modular Cooking - Grandis

### Gas - Range

#### NGR 12-90 GR



Due to continuous technical development, the image shown may not represent the latest design of the unit.

#### DESCRIPTION

Modular gas open burner with 900 mm depth and 6 hobs, 3 sets of 5.5 kW and 10 kW cast iron burners. Static 2/1 GN gas oven with 8 kW tubular burner.

Usable for boiling, steaming, frying, braising, simmering and steam frying. Oven module usable for roasting and baking.

Made of AISI 304 with 2 mm top thickness, manual ignited, fully welded basin for hygiene purpose, galvanized coated cast iron burner. Oven is sized for 2/1 GN with reflective AISI cavity for superior heat transfer.

#### OTHER AVAILABLE MODELS

- NGR 8-90 GR
- NGTR 12-90 GR
- NGTR 8-90 GR
- NGTR 4-90 GR
- NGR 8-90 DFX EOVR
- NGR 12-90 DFX EOVR

#### MAIN FEATURES

- Powered with a 6 hobs, 3 sets of 5.5 kW and 10 kW cast iron open burner.
- Static 2/1 GN gas oven is powered with 8 kW chrome-plated tubular burner with 2/1 GN cavity and reflective AISI chamber to improve thermal efficiency. Oven is equipped with piezo ignition system with rubber cover.
- Fully-welded basin for hygiene.
- Cast iron pot holder with long fin to support various size of pot or pan.
- Equipped with flame failure device.
- The optimized pan diameter for 5.5 kW burner is between 240-460 mm.
- The optimized pan diameter for 10 kW burner is between 300-500 mm.

#### CONSTRUCTION

- External construction entirely with AISI 304.
- Top panel with 2 mm thickness. Orbital surface finishing: resistant toward scratches.
- Front panel is constructed of 1 mm AISI 304 with satin surface finish.
- Side panel is constructed of 0.8 mm AISI 304 with satin surface finish.
- Adjustable +/- 25 mm AISI leg.
- Cabinet executed with H2 radius.
- Connector between Grandis product on the front and the back.

#### INCLUDED ACCESSORIES

- G20 Conversion Kit
- 2/1 GN oven wire tray (1 pcs.).
- Cast iron pot holder.

#### OPTIONAL ACCESSORIES

- Stainless steel pot holder GR.
- Joint clip GR.

## FRONT

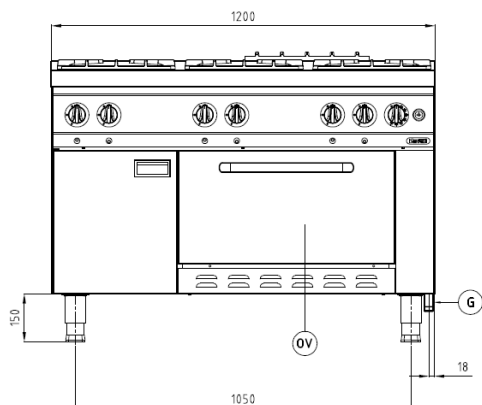

## TOP

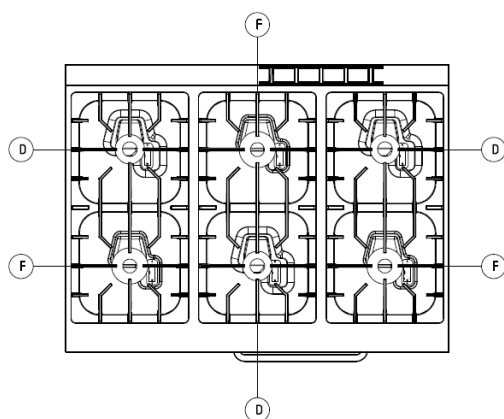

## SIDE

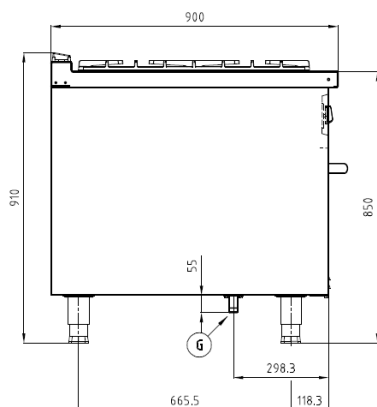

\*Overall dimension in mm

## TECHNICAL DATA

### External Dimensions

Width	: 1200 mm
Depth	: 900 mm
Height	: 850/910 mm

### Cooking Surface

Cooking zones	: Open Burner : 3 x 370 x 725 mm, Oven : 575 x 666 mm
---------------	--

### Gas Power Rating

Heat input total	: LPG/Natural Gas 54.5 kW
No. of burners	: 7
Control type	: Open burner: High - low power control, Oven: Modulating temperature control

Gas type options	: LPG G30, G31 Natural Gas G20, G25
------------------	--

### Connections

Gas	: DN 20 (3/4")
Water	: N/A
Drain	: N/A

### Heat & Steam Emissions

Direct heat emission	: 13.05 kW
Latent heat emission	: 5.7 kW
Steam emission	: 8.37 kg/h

### PACKAGING DATA

Width	: 1230 mm
Depth	: 930 mm
Height	: 1030 mm
Volume	: 1.18 m <sup>3</sup>

### WEIGHT

Net Weight	: 148 kg
Gross Weight	: 198 kg

PT. NAYATI INDONESIA

[www.nayati.com](http://www.nayati.com)

Nayati reserves the right to make product alterations and or price adjustments at any time and can not be held responsible for any printing errors or omissions.

07/02/2023