

Modular Cooking - Grandis

Gas - Tilting Pan

NGTP 80 GR



Due to continuous technical development, the image shown may not represent the latest design of the unit.

DESCRIPTION

Modular gas tilting braising pan with 900 mm depth and 80 liters capacity. Powered with 21 kW chrome-plated tubular burners.

Usable for multitude application: boiling, steaming, frying, braising and simmering.

Made of AISI 304 with 2 mm top thickness, griddle is made of 10 mm thick AISI 420, knife steel, that prevent rust and deliver good thermal conductivity. Manual tilting with the option of motorized tilting.

OTHER AVAILABLE MODELS

- NGTP 120 GR

MAIN FEATURES

- Powered with 21 kW chrome-plated tubular burner.
- Gross capacity of 80 liters and net capacity of 65 liters. Manual tilting operation.
- Welded AISI griddle AISI 420 with thickness of 10 mm, preventing rust.
- Temperature control from 100 to 300 degree Celcius.
- Piezzo ignition system with rubber cover.
- Equipped with flame failure device.

CONSTRUCTION

- External construction entirely with AISI 304.
- Top panel with 2 mm thickness. Orbital surface finishing: resistant toward scratches.
- Front panel is constructed of 1 mm AISI 304 with satin surface finish.
- Side panel is constructed of 0.8 mm AISI 304 with satin surface finish.
- Adjustable +/- 25 mm AISI leg.
- Cabinet executed with H2 radius.
- Connector between Grandis product on the front and the back.

INCLUDED ACCESSORIES

- G20 Conversion Kit
- Grandis joining clip.

OPTIONAL ACCESSORIES

- Joint clip GR.
- Motorized-tilting option.

FRONT

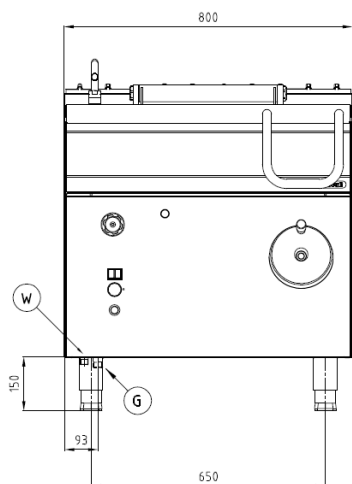

TOP

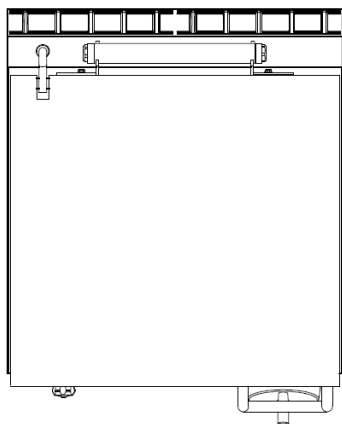

SIDE

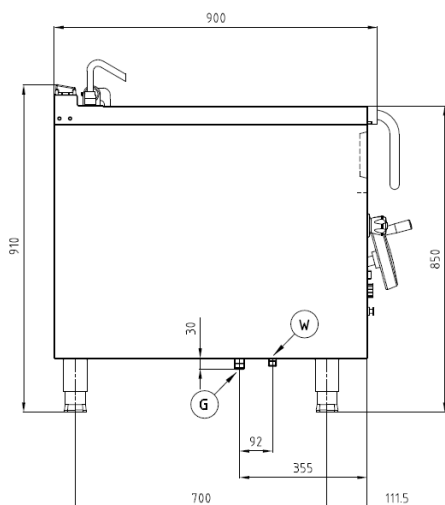

*Overall dimension in mm

TECHNICAL DATA

External Dimensions

Width	: 800 mm
Depth	: 900 mm
Height	: 850/910 mm

Cooking Surface

Cooking zones	: 65 liters, 730 x 590 mm
---------------	---------------------------

Gas Power Rating

Heat input total	: LPG/Natural Gas 21 kW
No. of burners	: 1
Control type	: Modulating temperature control
Gas type options	: LPG G30, G31 Natural Gas G20, G25

Connections

Gas	: DN 20 (3/4")
Water	: DN 15 (1/2")
Drain	: N/A

Heat & Steam Emissions

Direct heat emission	: 9.45 kW
Latent heat emission	: 9.45 kW
Steam emission	: 13.23 kg/h

PACKAGING DATA

Width	: 830 mm
Depth	: 930 mm
Height	: 1030 mm
Volume	: 0.80 m ³

WEIGHT

Net Weight	: 161 kg
Gross Weight	: 184 kg

PT. NAYATI INDONESIA

www.nayati.com

Nayati reserves the right to make product alterations and or price adjustments at any time and can not be held responsible for any printing errors or omissions.

22/03/2022