

## Smart Oven - Deck Oven

### Gas - Deck Oven

#### NGDO 130-S



Due to continuous technical development, the image shown may not represent the latest design of the unit.

#### DESCRIPTION

Gas Deck Oven with the chamber size of 130 cm by 80 cm. Powered with two gas burners with total power rate of 14 kW. Includes steam device for superb baking results.

Usable for three bakery trays of 400 x 600 mm.

Operated through touch screen control with Multistep program. Includes on/off temperature management for better accuracy. Maximum working temperature of 300 degree Celcius.

#### OTHER AVAILABLE MODELS

- NGDO 1-S
- NGDO 100-SR

#### MAIN FEATURES

- Heated with maximum temperature of 300 degree Celcius.
- Capacity of three bakery trays of 400 x 600 mm.
- Lower opening oven door with stainless steel cylindrical handle bar.
- Framed door with glass window to observe baking results.
- Controlled through touch screen interface with multistep program.
- Temperature adjustment with on/off temperature control system for greater accuracy.
- Includes halogen lighting in the baking chamber.
- Equipped with adjustable feet.

#### CONSTRUCTION

- Exterior panel constructed from stainless steel 304.
- Tempered glass door made of double layer to insulate heat inside the chamber.
- Round bar stainless steel door handle.

#### INCLUDED ACCESSORIES

- Power cable.
- Pan hook.
- Baking chamber grill.

#### OPTIONAL ACCESSORIES

- Stand NDSO 130.
- Steam Device

PT. NAYATI INDONESIA

[www.nayati.com](http://www.nayati.com)

Nayati reserves the right to make product alterations and or price adjustments at any time and can not be held responsible for any printing errors or omissions.

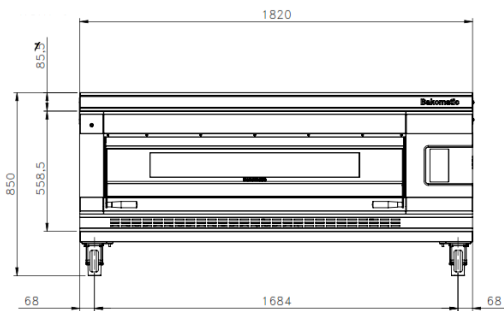
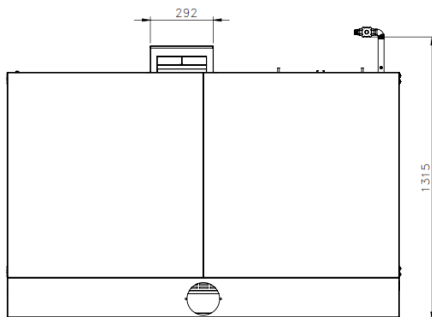
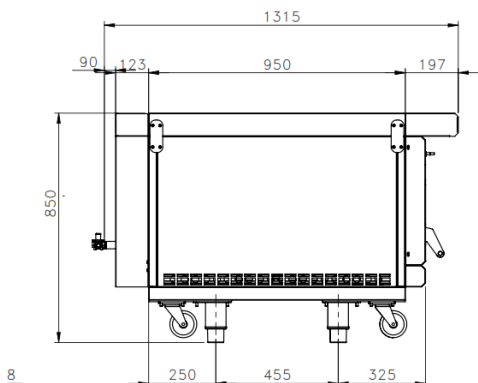
**FRONT****TOP****SIDE**

\*Overall dimension in mm

**TECHNICAL DATA****External Dimensions**

Width	: 1820 mm
Depth	: 1360 mm
Height	: 828/845 mm

**Cooking Surface**

Cooking zones	: 1300 x 805 x 229 mm
---------------	-----------------------

**Gas Power Rating**

Heat input total	: LPG/LNG 14 kW
No. of burners	: 2
Control type	: Temperature control
Gas type options:	LPG G30, G31 LNG G20, G25

**Electrical Supply Data**

Total connected load	: 0.1 kW
Voltage	: 230V, 1NPE AC / 50-60 Hz
Recommended fuse	: 0.5 A (slow)

**Connections**

Gas	: DN 20 (3/4")
Water	: N/A
Drain	: N/A

**Heat & Steam Emissions**

Direct heat emission	: 4.9
Latent heat emission	: 2.8
Steam emission	: 4.1 kg/h

**PACKAGING DATA**

Width	: 1900 mm
Depth	: 1440 mm
Height	: 1090 mm
Volume	: 2.98 m <sup>3</sup>

**WEIGHT**

Net Weight	: 329 kg
Gross Weight	: 443 kg