

Modular Cooking - Grandis

Gas - Tilting Pan

NGTP 120 GR



Due to continuous technical development, the image shown may not represent the latest design of the unit.

DESCRIPTION

Modular gas tilting braising pan with 900 mm depth and 120 liters capacity. Powered with 30 kW chrome-plated tubular burners.

Usable for multitude application: boiling, steaming, frying, braising and simmering.

Made of AISI 304 with 2 mm top thickness, griddle is made of 10 mm thick AISI 420, knife steel, that prevent rust and deliver good thermal conductivity. Motorized tilting for ease of operation.

OTHER AVAILABLE MODELS

- NGTP 80 GR

MAIN FEATURES

- Powered with 30 kW chrome-plated tubular burner.
- Gross capacity of 120 liters and net capacity of 115 liters. Motorized tilting for ease of operation.
- Welded AISI griddle AISI 420 with thickness of 10 mm, preventing rust.
- Temperature control from 100 to 300 degree Celcius.
- Electric ignition system with rubber cover.
- Equipped with flame failure device.

CONSTRUCTION

- External construction entirely with AISI 304.
- Top panel with 2 mm thickness. Orbital surface finishing: resistant toward scratches.
- Front panel is constructed of 1 mm AISI 304 with satin surface finish.
- Side panel is constructed of 0.8 mm AISI 304 with satin surface finish.
- Adjustable +/- 25 mm AISI leg.
- Cabinet executed with H2 radius.
- Connector between Grandis product on the front and the back.

INCLUDED ACCESSORIES

- G20 Conversion Kit
- Grandis joining clip.

OPTIONAL ACCESSORIES

- Joint clip GR.

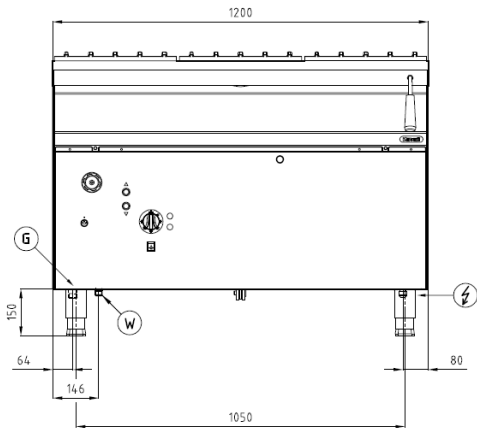
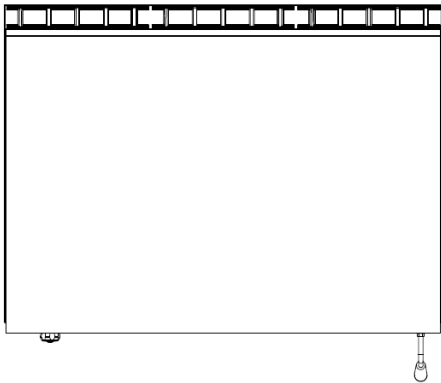
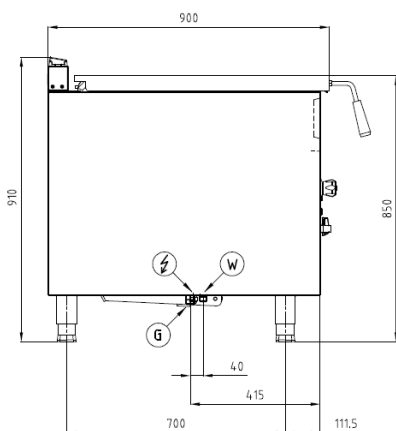
FRONT**TOP****SIDE**

*Overall dimension in mm

TECHNICAL DATA**External Dimensions**

Width	: 1200 mm
Depth	: 900 mm
Height	: 850/910 mm

Cooking Surface

Cooking zones : 115 liters, 1130 x 590 mm

Gas Power Rating

Heat input total	: LPG/Natural Gas 30 kW
No. of burners	: 1
Control type	: Modulating temperature control
Gas type options:	LPG G30, G31 Natural Gas G20, G25

Electrical Supply Data

Total connected load	: 0.32 kW
Voltage	: 230V, 1NPE AC / 50-60 Hz
Recommended fuse	: 2.5 A (slow)

Connections

Gas	: DN 20 (3/4")
Water	: DN 15 (1/2")
Drain	: N/A

Heat & Steam Emissions

Direct heat emission	: 13.5 kW
Latent heat emission	: 13.5 kW
Steam emission	: 18.9 kg/h

PACKAGING DATA

Width	: 1230 mm
Depth	: 930 mm
Height	: 1030 mm
Volume	: 1.18 m ³

WEIGHT

Net Weight	: 224 kg
Gross Weight	: 278 kg