

Asian Cooking - Wok Range

Gas - Wok Kwalie / CE

NGK S 120-75 W3



Due to continuous technical development, the image shown may not represent the latest design of the unit.

DESCRIPTION

Gas wok with three high-performance jet-burners, each with a power rate of 24.5/34 kW (LPG/LNG). Compact, powerful and suitable for various methods of Asian cooking, the NGK wok is the perfect choice for any kitchen.

Made of stainless steel AISI 304 with a slanted, deep drawn 3.2 mm strong, reinforced top panel with heavy-duty removable cast iron wok rings. Coldwater supply with three swivel faucets, mounted on the backsplash, easily operable from the front panel.

The intelligent deck cooling & cleaning system with spray nozzles guarantee an efficient cooling of the top panel and an enhanced hygienic as food debris are flushed away towards the drain channel in the back. The built-in strainer avoids congestions of the drain.

OTHER AVAILABLE MODELS

- NGK S 80-90 W2S1
- NGK S 80-90 W2S2

MAIN FEATURES

- Three atmospheric jet-burners with a power rate of 24.5/34 kW (LPG/LNG) each.
- Manual ignition.
- Equipped with pilot burners, safety thermocouples, gas valves, gas knee levers.
- Slanted, deep drawn, reinforced (3.2 mm) top panel with drain channel and removable strainer in the back for easy operation.
- Cold-water supply with three swivel faucets mounted on the backsplash.
- Deck cooling & cleaning system with spray nozzles for maximum hygiene.
- Suitable for wok-pan sizes Ø 14-18" (355-457 mm).
- CE certified unit.

CONSTRUCTION

- Sturdy frame made of stainless steel AISI 430.
- Slanted, reinforced deep drawn stainless steel top panel (3.2 mm), AISI 304 with hairline surface pattern.
- Front and side panels made of stainless steel AISI 304 with hairline surface pattern (0.8 mm).
- Backsplash made of stainless steel AISI 304 with hairline surface pattern (1.2 mm).
- Tubular, height adjustable (± 25 mm) stainless steel legs.
- Type of installation: free standing.
- Frame, top and panels, all made of high-grade stainless steel.

INCLUDED ACCESSORIES

- Wok stand (3 pcs)

OPTIONAL ACCESSORIES

- Condiment tray made of stainless steel AISI 304 (300x300 mm).

PT. NAYATI INDONESIA

www.nayati.com

Nayati reserves the right to make product alterations and or price adjustments at any time and can not be held responsible for any printing errors or omissions.

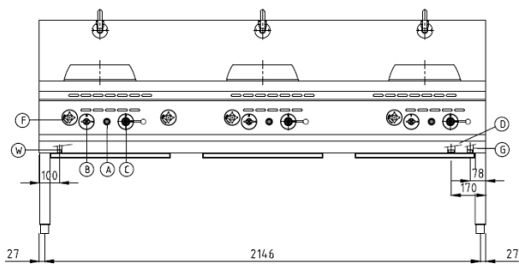
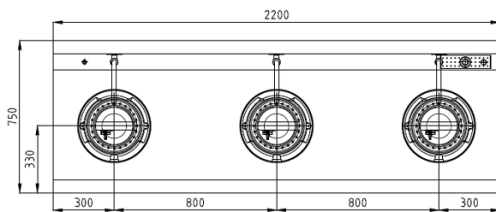
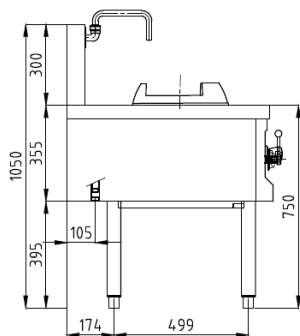
FRONT**TOP****SIDE**

*Overall dimension in mm

TECHNICAL DATA**External Dimensions**

Width	: 2200 mm
Depth	: 750 mm
Height	: 750/1050 mm

Cooking Surface

Wok burners	: 3 x Ø 280 mm
Soup burners	: N/A

Gas Power Rating

Heat input total	: LPG 73.5 kW, Natural Gas 102 kW
No. of burners	: 3
Control type	: Open-close valve
Gas type options	: LPG G30, G31 Natural Gas G20, G25

Connections

Gas	: DN25 (1")
Water	: DN15 (1/2")
Drain	: DN25 (1")

Heat & Steam Emissions

Direct heat emission	: LPG 18.38 kW , Natural Gas 25.50 kW
Latent heat emission	: LPG 11.03 kW , Natural Gas 15.30 kW
Steam emission	: LPG 19.48 kg/h , Natural Gas 27.03 kg/h

PACKAGING DATA

Width	: 2230 mm
Depth	: 780 mm
Height	: 1170 mm
Volume	: 2.04 m ³

WEIGHT

Net Weight	: 156 kg
Gross Weight	: 200 kg