

Asian Cooking - Pot Cooker

Gas - Pot Cooker

NGTL 12-75



Due to continuous technical development, the image shown may not represent the latest design of the unit.

DESCRIPTION

Gas pot cooker with two powerful burners, each with a power rate of 24 kW. Compact design with height adjustable legs and a backsplash.

Designed for durability to cater medium volume of boiling and simmering, this stock pot cooker is the perfect solution for every Asian kitchen.

Made of stainless steel with a with a 1.2 mm strong top panel. The burners are equipped with cast iron potholders.

OTHER AVAILABLE MODELS

- NGTL 6-75
- NGTL 6-75 NSB
- NGETL 5-50
- NGTL 6-75 H
- NGTL 12-75 H

MAIN FEATURES

- Two atmospheric burners with a power rate of 24 kW each.
- Two large cast iron potholders for heavy duty use.
- Manual ignition.
- Equipped with pilot burners, safety thermo-couples, gas valves and gas control knobs.

CONSTRUCTION

- Sturdy frame made of stainless steel AISI 430.
- Stainless steel top panel (1.2 mm), AISI 304 with orbital surface pattern.
- Front and side panels made of stainless steel AISI 430 with hairline surface pattern (1.0 mm).
- Backsplash made of stainless steel AISI 304 with hairline surface pattern (1.0 mm).
- Tubular, height adjustable (± 25 mm) stainless steel legs.
- Type of installation: free standing.
- Frame, top, panels and legs all made of high-grade stainless steel.

INCLUDED ACCESSORIES

- Cast iron pot holder

OPTIONAL ACCESSORIES

- N/A

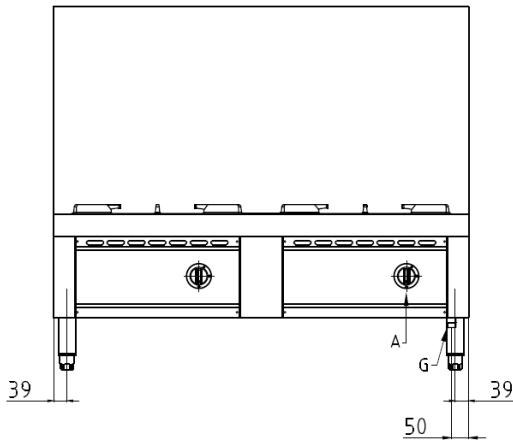
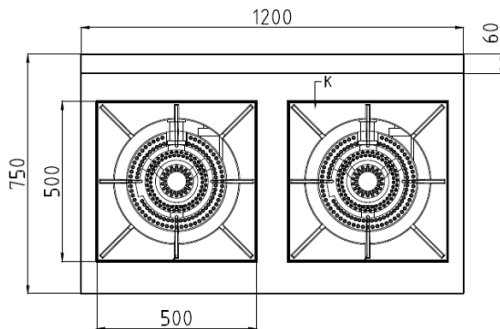
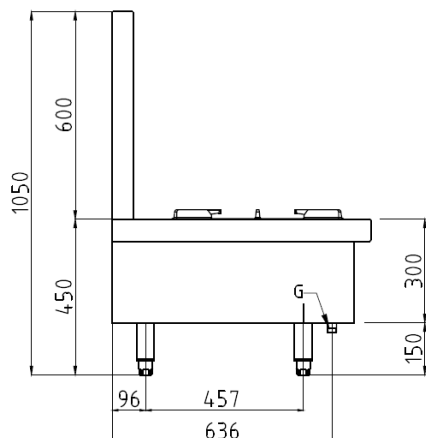
FRONT**TOP****SIDE**

*Overall dimension in mm

TECHNICAL DATA**External Dimensions**

Width	: 1200 mm
Depth	: 750 mm
Height	: 450/1050 mm

Cooking Surface

Wok burners	: 2 x Ø 500 mm
Soup burners	: N/A

Gas Power Rating

Heat input total	: LPG/Natural Gas 48 kW
No. of burners	: 2
Control type	: High-low power control
Gas type options	: LPG G30, G31 Natural Gas G20, G25

Connections

Gas	: DN 20 (3/4")
Water	: N/A
Drain	: N/A

Heat & Steam Emissions

Direct heat emission	: LPG/Natural Gas 12 kW
Latent heat emission	: LPG/Natural Gas 7.2 kW
Steam emission	: LPG/Natural Gas 12.72 kg/h

PACKAGING DATA

Width	: 1230 mm
Depth	: 780 mm
Height	: 1120 mm
Volume	: 1.07 m ³

WEIGHT

Net Weight	: 75 kg
Gross Weight	: 102 kg

PT. NAYATI INDONESIAwww.nayati.com

Nayati reserves the right to make product alterations and or price adjustments at any time and can not be held responsible for any printing errors or omissions.

16/01/2023