

Modular Cooking - Meritus

Neutral Counter

NNWC 6-75 1D (ME)



Due to continuous technical development, the image shown may not represent the latest design of the unit.

DESCRIPTION

Modular neutral working counter with 750 mm depth, 4500 square-centimeter working area. Equipped with drawer.

Usable for preparation phase before/after cooking processes and storage of crockery and tools.

Made of AISI 304 with 1.5 mm top thickness.

OTHER AVAILABLE MODELS

- NNWC 4-75 (ME)
- NNWC 6-75 (ME)
- NNWC 8-75 (ME)
- NNWC 4-75 1D (ME)
- NNWC 8-75 2D (ME)
- NNWC 4-75 SD (ME)
- NNWC 6-75 SD (ME)
- NNWC 8-75 SD (ME)
- NNWC 4-75 1D/SD (ME)
- NNWC 6-75 1D/SD (ME)
- NNWC 8-75 2D/SD (ME)

MAIN FEATURES

- Neutral working counter with 600 x 750 mm surface.
- Open cabinet without door.
- Equipped with drawer on the front panel.

CONSTRUCTION

- External construction entirely with AISI 304.
- Top panel with 1.5 mm thickness. Orbital surface finishing: resistant toward scratches.
- Front panel is constructed of 0.8 mm AISI 304 with satin surface finish.
- Side panel is constructed of 0.8 mm AISI 304 with satin surface finish.
- Adjustable +/- 25 mm AISI leg.
- Nayati connection system between Meritus products on the front panels, cabinets, and splashbacks.
- Cabinet executed with H2 radius.
- Deep drawn front panel to minimize liquid penetration to the internal part.
- Gasket protection behind the knobs to prevent water to seeping in, prolonging main heating regulation parts.
- IPX5 water protection level.

INCLUDED ACCESSORIES

- Drawers.

OPTIONAL ACCESSORIES

- Joint clip ME.

FRONT

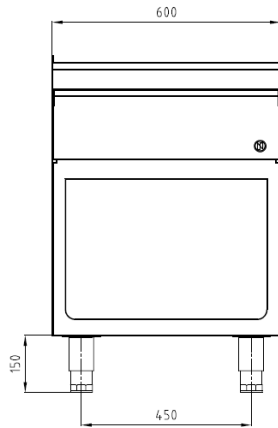

TOP

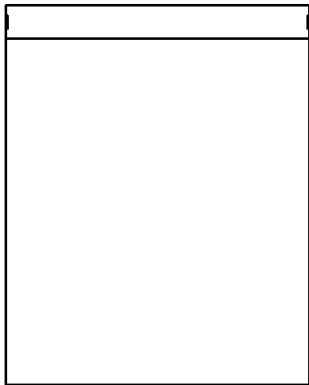

SIDE

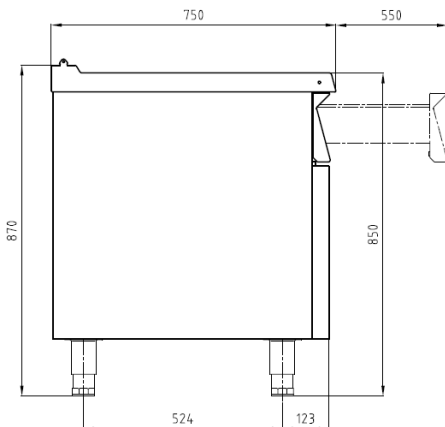

*Overall dimension in mm

TECHNICAL DATA

External Dimensions

Width : 600 mm
Depth : 750 mm
Height : 850/870 mm

PACKAGING DATA

Width : 630 mm
Depth : 780 mm
Height : 990 mm
Volume : 0.49 m³

WEIGHT

Net Weight : 58 kg
Gross Weight : 64 kg