

Modular Cooking - Grandis

Neutral Counter

NNWC 8-90 GR DR



Due to continuous technical development, the image shown may not represent the latest design of the unit.

DESCRIPTION

Modular neutral working counter with 900 mm depth, 7200 square-centimeter working area. Equipped with drawer.

Usable for preparation phase before/after cooking processes and storage of crockery and tools.

Made of AISI 304 with 2 mm top thickness.

OTHER AVAILABLE MODELS

- NNWC 4-90 GR
- NNWC 6-90 GR
- NNWC 8-90 GR
- NNWC 4-90 GR DR
- NNWC 6-90 GR DR
- NNWC 4-90 GR D
- NNWC 6-90 GR D
- NNWC 8-90 GR D
- NNWC 4-90 GR D DR
- NNWC 6-90 GR D DR
- NNWC 8-90 GR D DR

MAIN FEATURES

- Neutral working counter with 800 x 900 mm surface.
- Open cabinet without door.
- Equipped with drawer on the front panel.

CONSTRUCTION

- External construction entirely with AISI 304.
- Top panel with 2 mm thickness. Orbital surface finishing: resistant toward scratches.
- Front panel is constructed of 1 mm AISI 304 with satin surface finish.
- Side panel is constructed of 0.8 mm AISI 304 with satin surface finish.
- Adjustable +/- 25 mm AISI leg.
- Cabinet executed with H2 radius.
- Connector between Grandis product on the front and the back.
- IPX4 water protection level.

INCLUDED ACCESSORIES

- N/A

OPTIONAL ACCESSORIES

- Joint clip GR.

FRONT

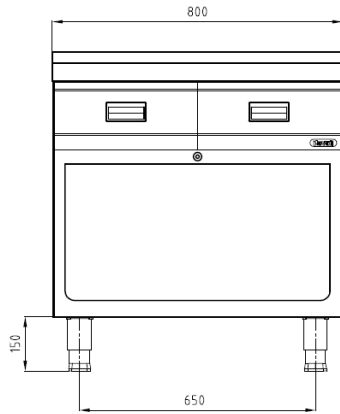

TOP

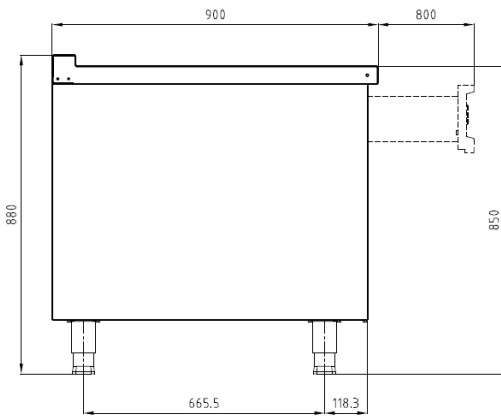

SIDE

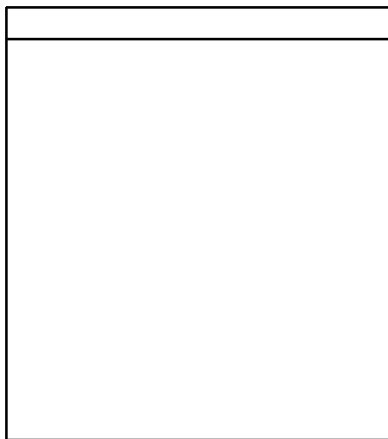

*Overall dimension in mm

TECHNICAL DATA

External Dimensions

Width : 800 mm
Depth : 900 mm
Height : 850/880 mm

PACKAGING DATA

Width : 830 mm
Depth : 930 mm
Height : 1000 mm
Volume : 0.77 m³

WEIGHT

Net Weight : 67 kg
Gross Weight : 89 kg

PT. NAYATI INDONESIA

www.nayati.com

Nayati reserves the right to make product alterations and or price adjustments at any time and can not be held responsible for any printing errors or omissions.

15/05/2020